



46 FLY

ELEGANCE, COMFORT,
PLEASURE AND MORE

**NAUTECH**
ELEVATE YOUR DREAM

PERFORMANCE

A FLYBRIDGE FOR THE PERFECT
VIEW OF THE SEASCAPE

With an optimised sail area / displacement ratio, the 46 Fly is dynamic and responsive in all sailing conditions. The flybridge offers a 360° viewpoint, the ideal place to observe the horizon in complete freedom.



The raised helm station combines protection and 360° visibility over the sea. With all manoeuvre led back to the helm station, sailing is simple and safe. Enjoy every moment in complete peace of mind, whatever the sea conditions.





Modular and functional living spaces that suit any time of day. Relaxing, dining, entertaining... whatever the activity there is a space to accommodate it. The flybridge is not just a place for manoeuvring, it is a complete living space with a coffee table that transforms into a huge sunbathing area.



LIFESTYLE

THE PLEASURE OF SHARING EVERY MOMENT

Large volumes and bright interiors offer you ever more pleasure. Every detail has been designed to make your experience on board as comfortable and luxurious as possible. All cabins enjoy an exceptional view of the sea and their own bathroom for maximum privacy.

COMFORT

THE IMPORTANCE OF DETAIL



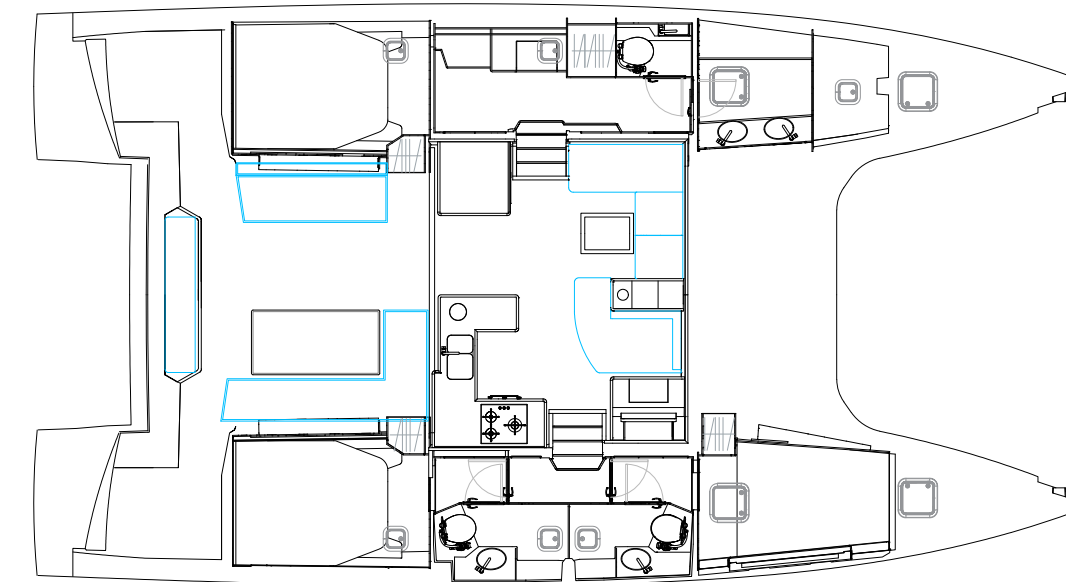

3 cabins

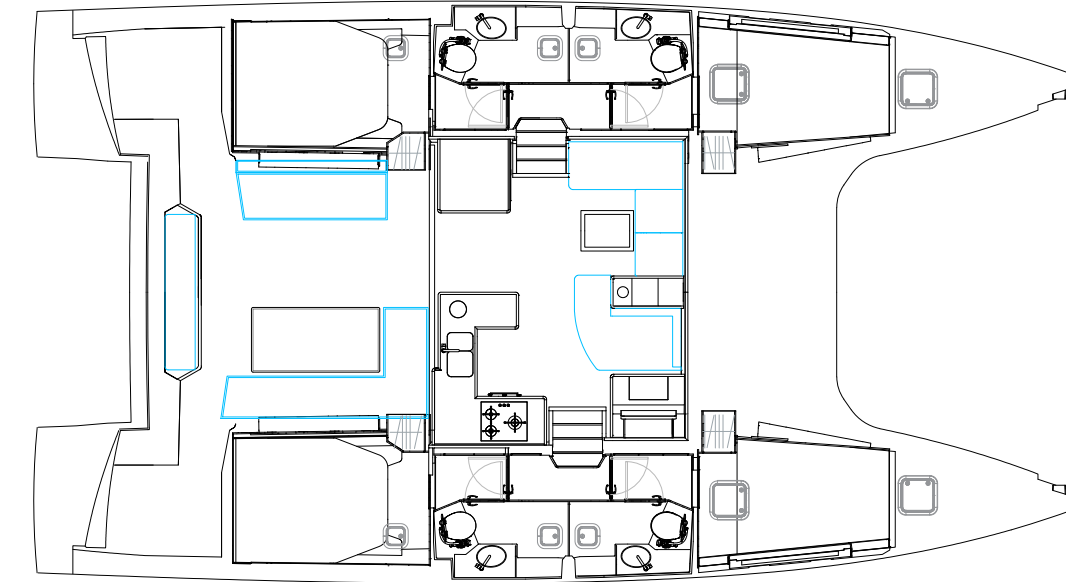

4 cabins

TECHNICAL DATA

Overall Length	13,79 m / 45'3"
Waterline length	13,71 m / 45'0"
Beam overall	7,54 m / 24'9"
Draft	1,45 m / 4'9"
Unloaded weight (approx.)	11,4 t / 25 133 lbs
Engine, Drive	Diesel, Saildrive
Engine power	2 x 40 cv Volvo Penta
Fuel tank	2 x 300 L / 2 x 79 gal
Water tank	2 x 300 L / 2 x 79 gal
Cabins - Heads, standard	3 to 4
Berths, standard version	6 to 8
Full batten mainsail, standard	69 sqm / 743 sq ft
Self-tacking jib, standard	38 sqm / 409 sq ft
Architect	Marc Lombard



NAUTITECH

MAKE
EXCELLENCY
YOUR STANDARD

NAUTITECH CATAMARANS: THE PERFECT BALANCE BETWEEN PERFORMANCE AND COMFORT

My relationship with NAUTITECH CATAMARANS, started in 2009 with the design of the Nautitech 54'. The brief was to create the perfect balance between performance and comfort, for private customers who are keen sailors but want the comforts of modern living too. We also wanted to appeal to sailors who charter a yacht, but do not want it to just be a floating caravan. What I mean by «performance» is genuine sensations at the helm, good top speed when conditions are favourable, and more specifically, high average speed upwind and downwind, without forgetting the important aspect of the time spent motoring, which is frequent with long-distance cruising. And all this without ever having to worry about safety in family navigation conditions. On deck everything is designed to be simple and reliable, easy to be manoeuvred by a reduced crew.

Marc LOMBARD
Naval Architect

A LONG-TERM VISION PROMOTING EXCELLENCY

Running a successful shipyard is a dream come true for the team behind NAUTITECH CATAMARANS. Passion for the sea and shipbuilding is shared throughout every department, and this passion is a fundamental foundation for our company. We believe that navigation must be at the heart of a multihull's DNA. While the current market trend increasingly promotes the catamaran experience as a static one, we design boats that are remarkable when stationary and when blue water cruising. Our customers expect us to be able to sail by maximizing their experience on the water as well as the sensations felt. It is therefore imperative for us to project the future of our catamarans in solutions combining ease of use, comfort in navigation, performance, safety in all wind conditions.

Gildas LE MASSON
CEO



THE BRAND

It is in Rochefort sur Mer, the very cradle of shipbuilding and naval architecture and birthplace of Pierre Loti, that NAUTITECH CATAMARANS has anchored its activity of construction of luxury catamarans. Anyone familiar with the world of multihulls can quickly appreciate the innovative nature of NAUTITECH CATAMARANS, the first manufacturer to understand and define the very spirit of a catamaran. Nautitech were also the first to propose the concept of open living onboard, that combines the saloon and cockpit into one spacious, functional living area. Understanding how important sensations at the helm are to their customers, NAUTITECH CATAMARANS places equal emphasis on sailing ability and comfort. To date, NAUTITECH CATAMARANS has 200 employees, 80 catamarans built per year; 80% export worldwide, via more than 50 agents..





www.nautitechcatamarans.com